

LOCATION MAP

SCALE: 1" = 2000'

- LEGEND**
THESE SYMBOLS WILL BE USED IN THE DRAWING.
- CL CONSTRUCTION LIMIT
 - PL PROPERTY LINE
 - STREAM CHANNEL
 - CURTAIN DRAIN
 - BENCH MARK LOCATION
 - GATE VALVE LOCATION
 - UTILITY POLE
 - SAMPLE POINT LOCATION
 - GUIDE RAIL
 - WATER CONTROL STRUCTURE
 - ROCK LINED WATERWAY
 - BAFFLE LOCATION
 - TOP OF DAM

- NOTES:**
- SEVERAL OF THE BENCH MARK LOCATIONS ARE NOT SHOWN ON THIS PLAN VIEW.
 - SEE SHEET #7 FOR THE VERTICAL FLOW WETLANDS PIPE LAYOUTS AND DETAILS.

BENCH MARK DATA				
BM NO.	ELEVATION	DESCRIPTION	N. COORDINATE	E. COORDINATE
DEP-1	1410.72	5/8" REBAR WITH CAP	263939.90	1505869.85
DEP-2	1404.83	5/8" REBAR WITH CAP	264686.33	1507677.21
T-1002	1429.69	HUB & TACK	264677.18	1507268.82
T-1007	1413.11	HUB & TACK	264565.85	1507450.90
HVP1-2	1407.59	LONE TREE	263659.13	1505652.35

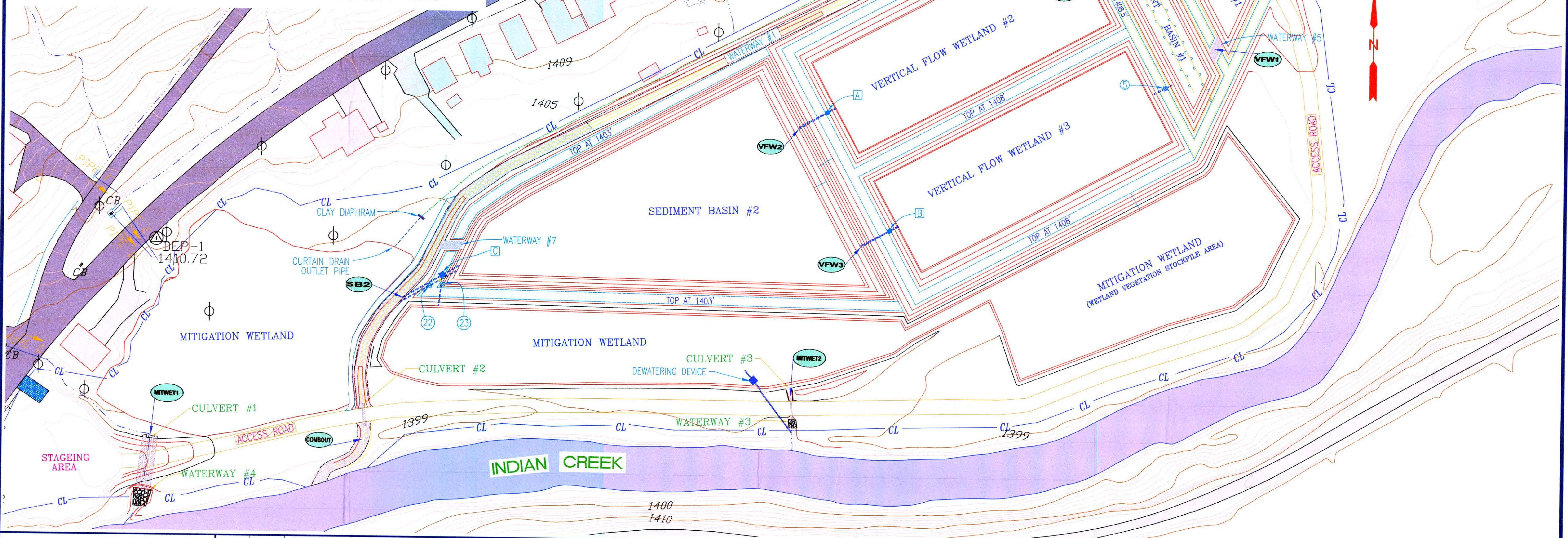

Routine Monitoring Form	
Project (Name/Number): Indian Creek/PA 2767	
Monitoring Point Alias:	Point Description:
KALPDBRAW	Raw dsq from Dir. Boreholes
VFW1	Vertical flow wetland #1 Outlet
SB1	Sediment Basin #1 Outlet
VFW2	Vertical flow wetland #2 Outlet (RT 711 side)
VFW3	Vertical flow wetland #3 Outlet (Indian Ck side)
SB2	Sediment Basin #2 Outlet (sys final effluent)
COMBOUT	Combined flow wetland #2 and bypass at outlet
MITWET1	Discharge from Mit Wet #1 (lower end of site)
MITWET2	Discharge from Mit Wet #2 (near VFW3)
IC4*	Indian Ck. US Kalp Sys (300' DS Champion Ck.)
IC5*	Indian Ck. DS Kalp Sys at Sagamore Bridge
IC6*	Indian Ck. at Indian Head (upstream of Back Ck.)

* These Points are shown on the Location Map

NO.	BY	DATE	DESCRIPTION
REVISIONS			

SUBMITTED BY: _____

PROJECT DESIGNER: _____

RECOMMENDED BY: _____

DESIGN SECTION CHIEF - CAMBRIA OFFICE: _____

APPROVED BY: _____

ENVIRONMENTAL PROGRAM MANAGER - CAMBRIA OFFICE: _____