

Timothy Brian Flock P.E.

Benchmark Engineering
 & construction co.,inc.
 "A STANDARD BY WHICH OTHERS ARE MEASURED"
 PO BOX 53, ROUTE 30, LAUGHLINTOWN PA 15655-0053
 Phone: (724) 238-2955 Fax: (724) 238-5242

**AS-BUILT FOR
KLONDIKE PASSIVE TREATMENT
POND 1**

| | | | | |
|------------|---------------------------|----------|---------|----------|
| DRAWN BY | C.J.M. | F.B. 197 | DATE | DWG. NO. |
| CHECKED BY | T.B.F. | Pg. 68 | 2/27/08 | 2 of 4 |
| REVISION | DESCRIPTION | | | |
| 11/12/08 | REVISION TO CCWA COMMENTS | | | |
| | | | | |
| | | | | |

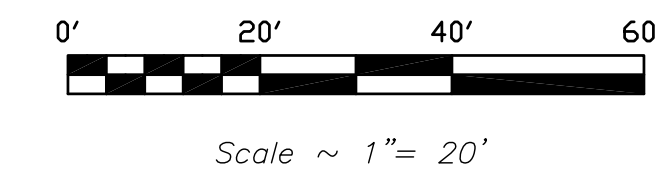

LEGEND

- 1' CONTOURS
- 2210 --- 5' CONTOURS
- 2:1 SLOPE (H:V)
- ACTUAL 6" PIPE LOCATIONS
- RIP RAP

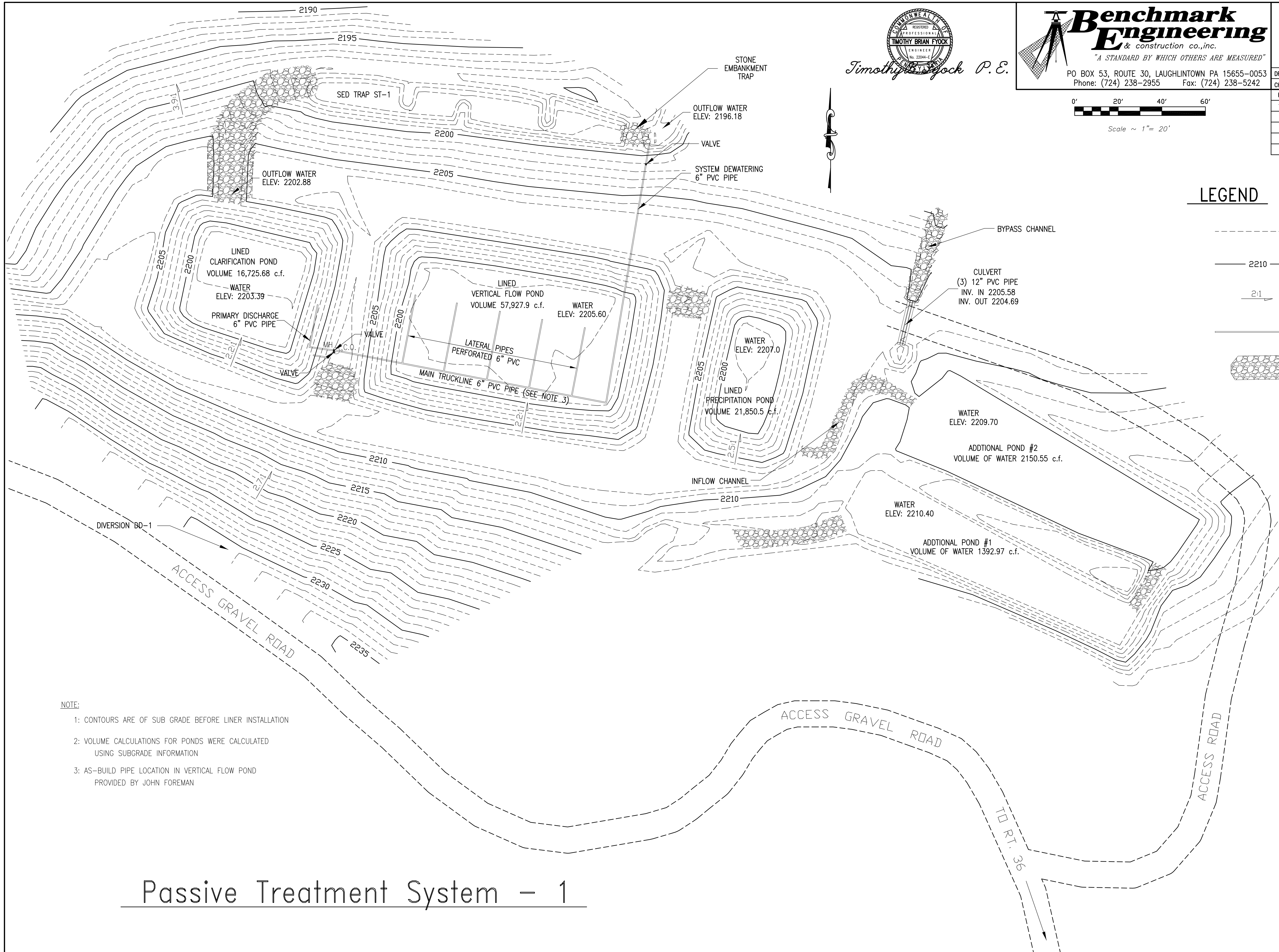

- NOTE:**
- 1: CONTOURS ARE OF SUB GRADE BEFORE LINER INSTALLATION
 - 2: VOLUME CALCULATIONS FOR PONDS WERE CALCULATED USING SUBGRADE INFORMATION
 - 3: AS-BUILD PIPE LOCATION IN VERTICAL FLOW POND PROVIDED BY JOHN FOREMAN

Passive Treatment System - 1