

PLAN VIEW: FERRIS TREATMENT COMPLEX

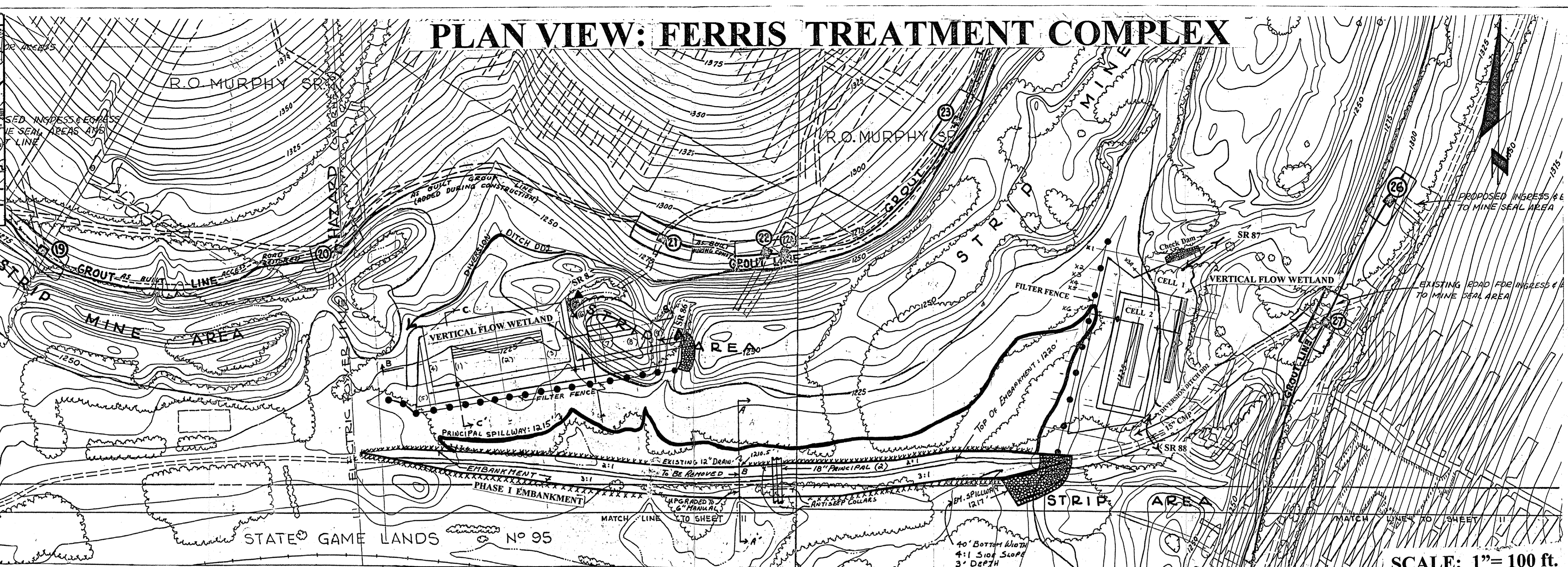

SCALE: 1" = 100 ft.

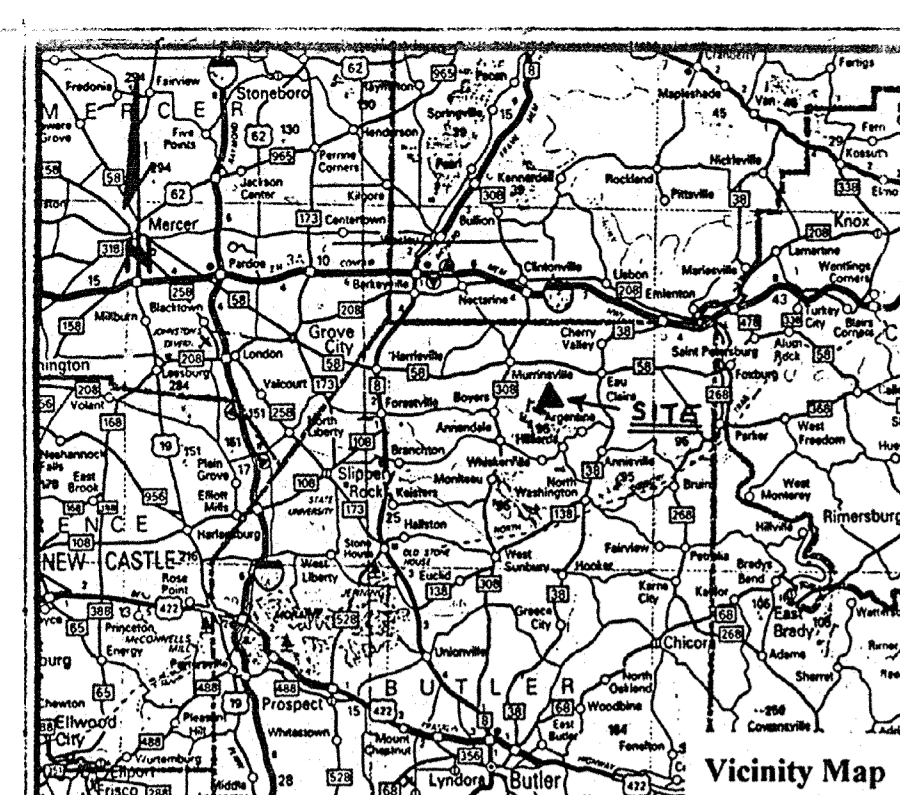
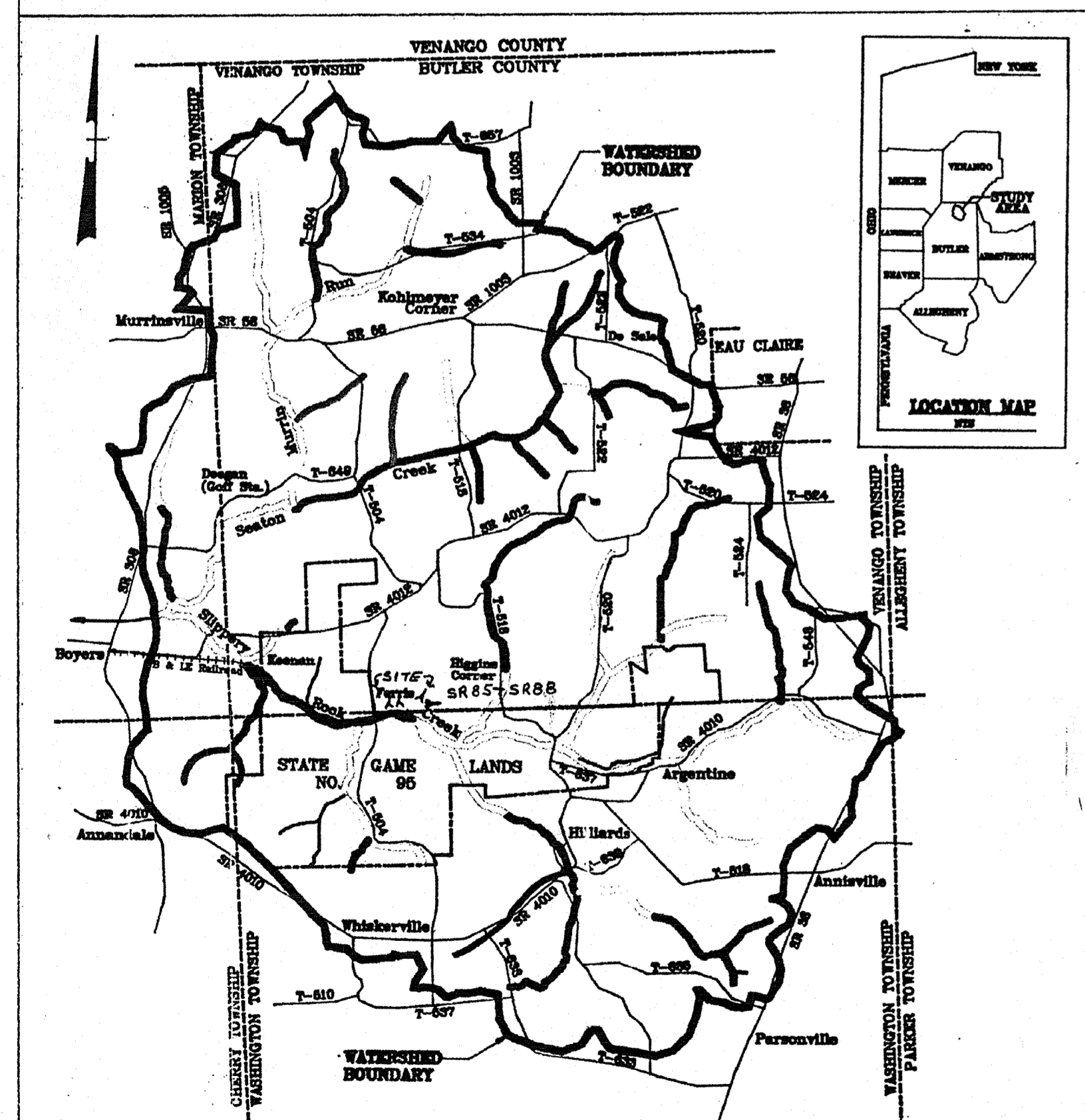

Key to Stream Quality Designations
 GOOD (pH > 6, acidity < alkalinity, iron < 1.0mg/l)
 MARGINAL/acid sensitive (pH 5 to 6, sulfates < 50mg/l)
 MARGINAL/acid drainage impacted (pH 5 to 6, sulfates > 50mg/l)
 POLLUTED (pH < 5, acidity > alkalinity, iron > 1.5mg/l)
 UNDESAMPLED

STREAM QUALITY MAP
 portion of Slippery Rock Creek Watershed (87 square miles)
 Butler County, Pennsylvania
 Scale 1" = 1 mile Date: 12/94

GRAPHIC SCALE: 0 0.5 1 2

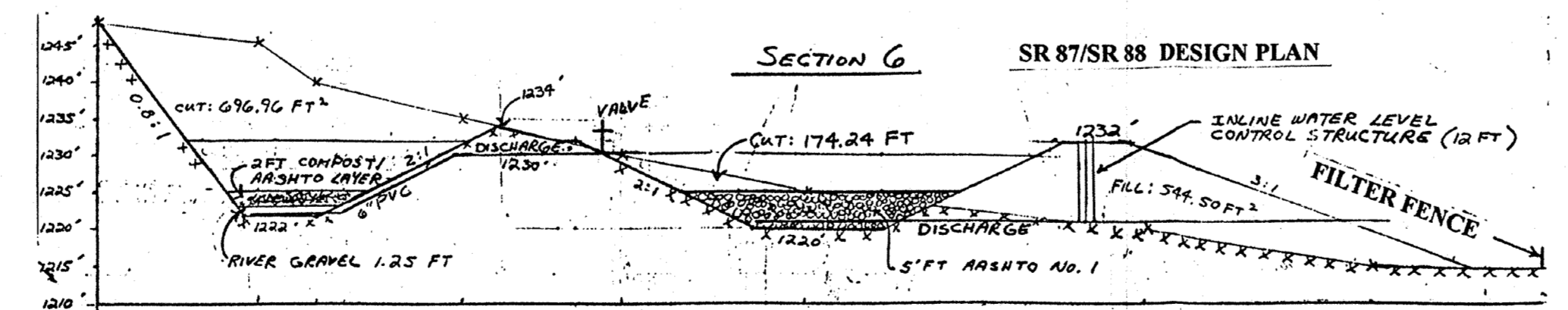
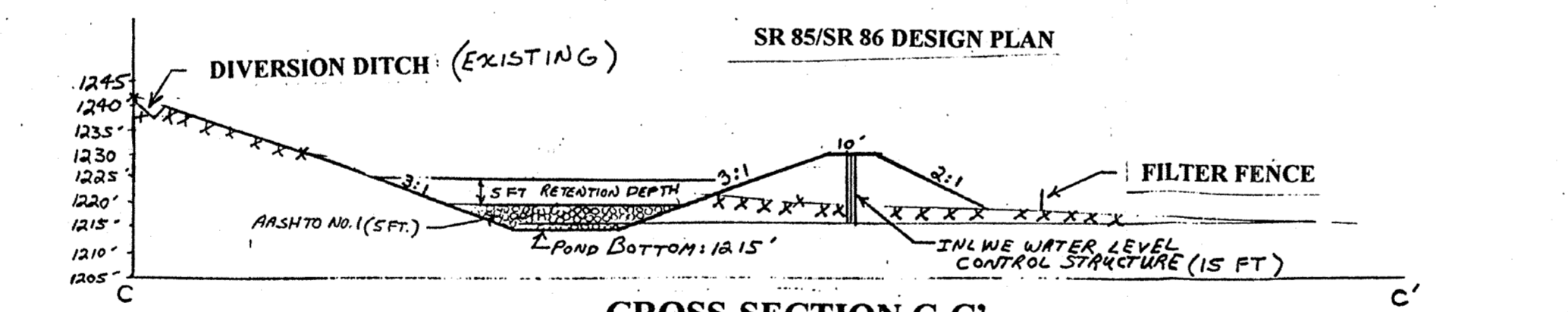
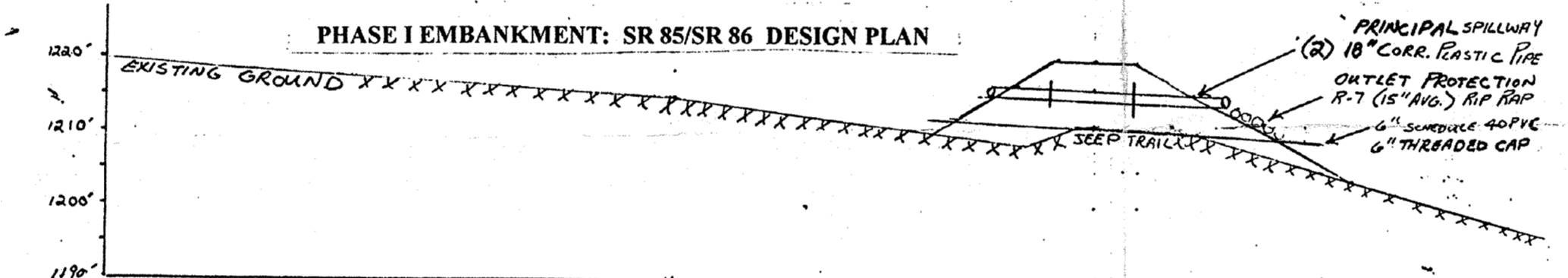

INLINE WATER LEVEL CONTROL STRUCTURE

- Rugged 1/2" PVC structure.
- Stainless steel screws and custom anodized aluminum corner connections are used for strength and durability.
- Soft rubber is attached to the stoplogs for a near perfect seal.
- 5' & 7' stoplogs for adjustability.
- Flexible couplers allow PVC, plastic pipe or other materials to be easily attached. (Please specify type of pipe when ordering)
- Adjustable for any project.
- Heavy steel lockable top and handle included.

PIPE SIZE	2'	3'	4'	5'	6'	7'	8'	9'	10'	11'	12'	13'	14'
4"	\$230	\$250	\$270	\$290	\$310	\$330	\$350	\$420	\$440	\$460	\$500	\$520	
6"	235	255	275	295	315	335	355	425	445	465	505	525	
8"	250	280	310	340	370	400	430	510	540	570	600	630	660
10"	270	300	330	360	390	420	450	530	560	590	620	650	680
12"	325	360	395	425	460	495	525	605	635	665	695	725	755
15"	350	395	425	460	495	525	560	645	680	715	750	785	820
18"	380	420	460	500	540	580	620	710	750	790	830	870	910

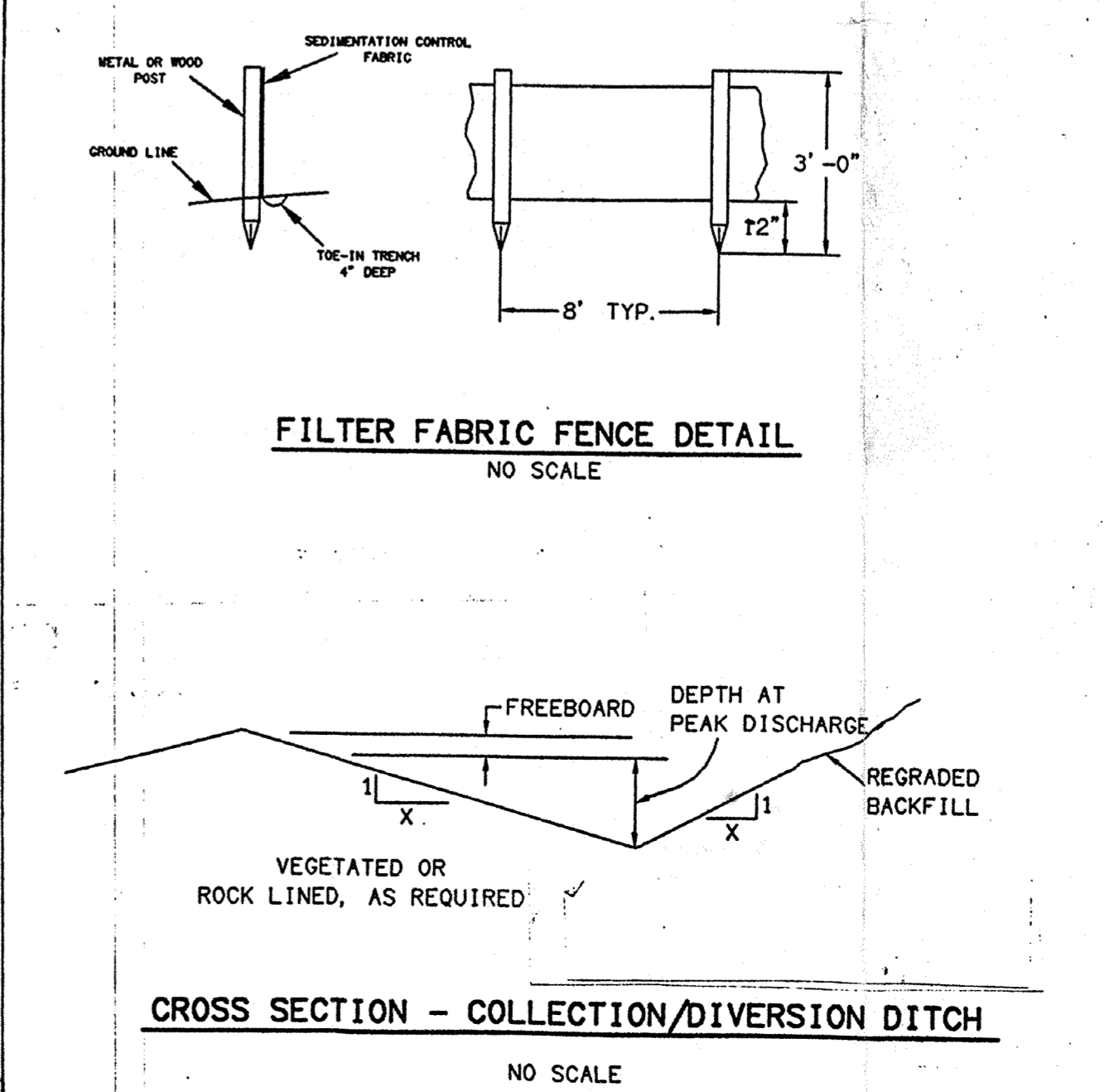

Revision

No.	Date	APPROVED

SUBMITTED BY:
 Douglas W. Caylor, P.E.
 Mining Engineer 2



Seal
 Timothy Gillen, P.G.
 Hydrogeologist 1

COMMONWEALTH OF PENNSYLVANIA
 DEPARTMENT OF ENVIRONMENTAL PROTECTION
 KNOX DISTRICT MINING OPERATIONS

SLIPPERY ROCK CREEK PROJECT
FERRIS PASSIVE TREATMENT COMPLEX
EROSION & SEDIMENTATION CONTROL PLAN

VENANGO TWP. BUTLER CO.
PLAN, DESIGN TYPICAL, AND LOCATION MAPS
 Design/Drawn by: Roger D. Bowman DATE: Sept. 12, 1996 SCALE: AS SHOWN