

**JB #2 AMD
GROWING GREENER
SMITH TOWNSHIP
WASHINGTON COUNTY, PENNSYLVANIA**

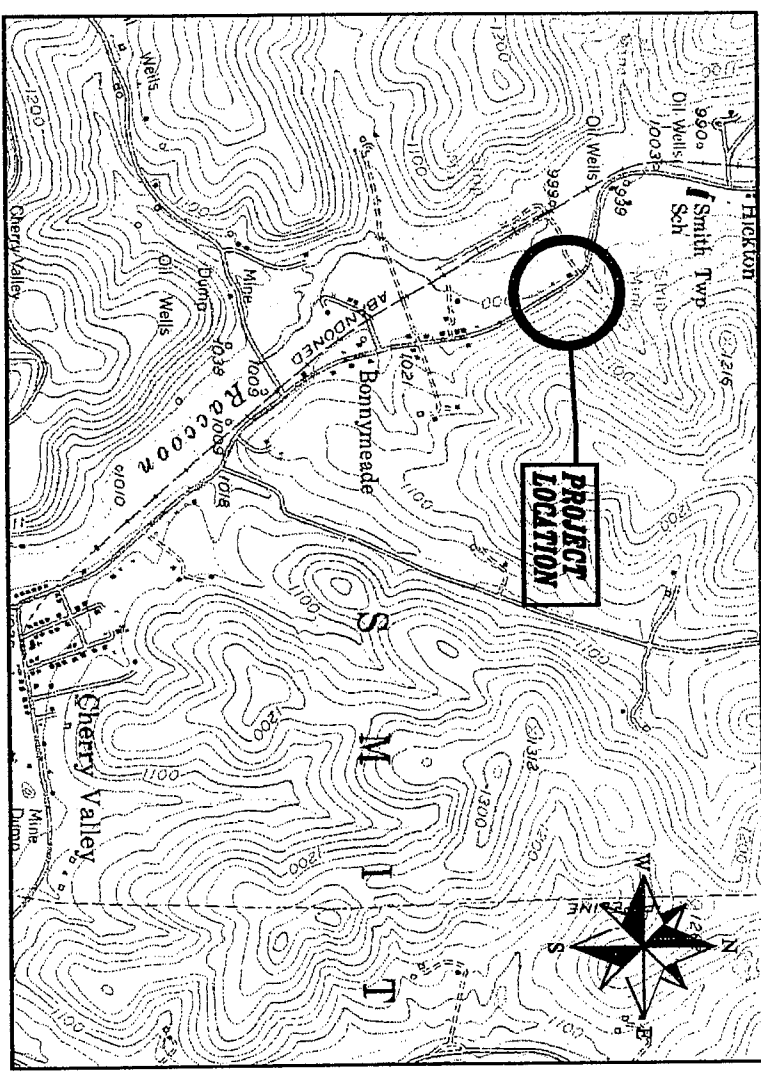

Sponsored By _____



**RACCOON CREEK WATERSHED ASSOCIATION
WASHINGTON COUNTY CONSERVATION DISTRICT
PA DEPARTMENT OF ENVIRONMENTAL PROTECTION**

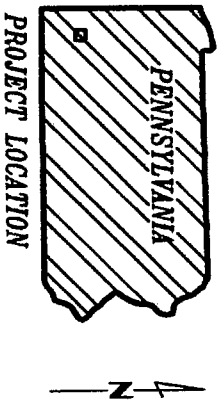

Prepared By _____

**UNITED STATES DEPARTMENT OF AGRICULTURE
NATURAL RESOURCES CONSERVATION SERVICE
PENNSYLVANIA ASSN OF CONSERVATION DISTRICTS
TECHNICAL ASSISTANCE GRANT PROGRAM**

2008

1. TITLE SHEET	INDEX
2. EXISTING PLAN VIEW	
3. FINAL PLAN VIEW	
4. PROFILES	
5. DETAILS	

GROUND CONTROL DATA				
NO	DESCRIPTION	NORTHING	EASTING	ELEVATION
BM 1	80D NAIL	5000.00	5000.00	200.00
BM 2	80D NAIL	4860.80	5016.94	189.14

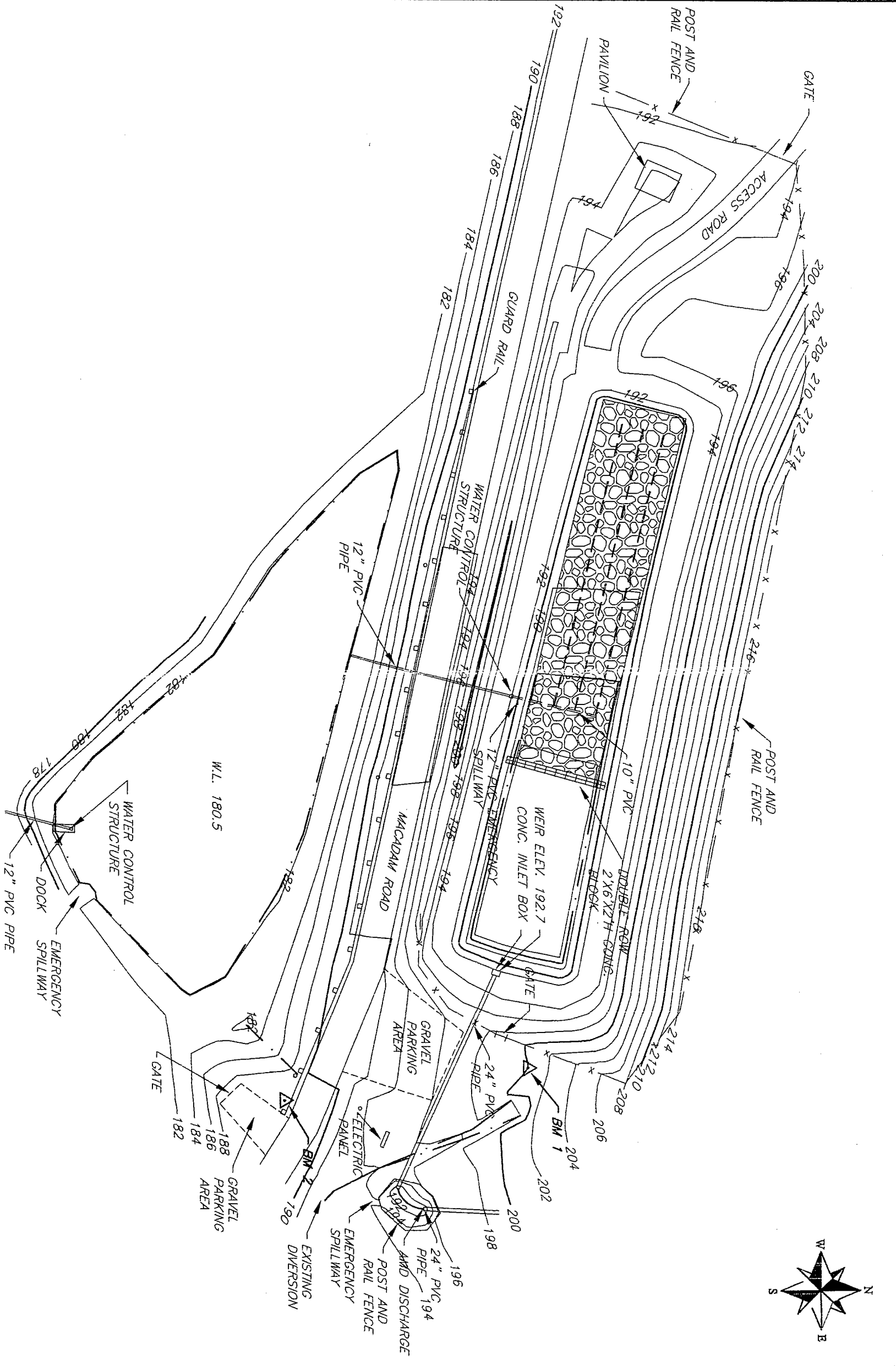

WASHINGTON COUNTY CONSERVATION DISTRICT
 JB #2 AND SITE
 WASHINGTON COUNTY, PENNSYLVANIA
 EXISTING PLAN VIEW

USDA NRCS
 Natural Resources Conservation Service

Developed by	E. ROBERTSON	Date	11/08	Approved by	
Drawn by	E. ROBERTSON	Date	11/08	Title	
Reviewed by		Date		Title	
Checked by	PR	Date	11/08	Title	

Sheet 2 of 5

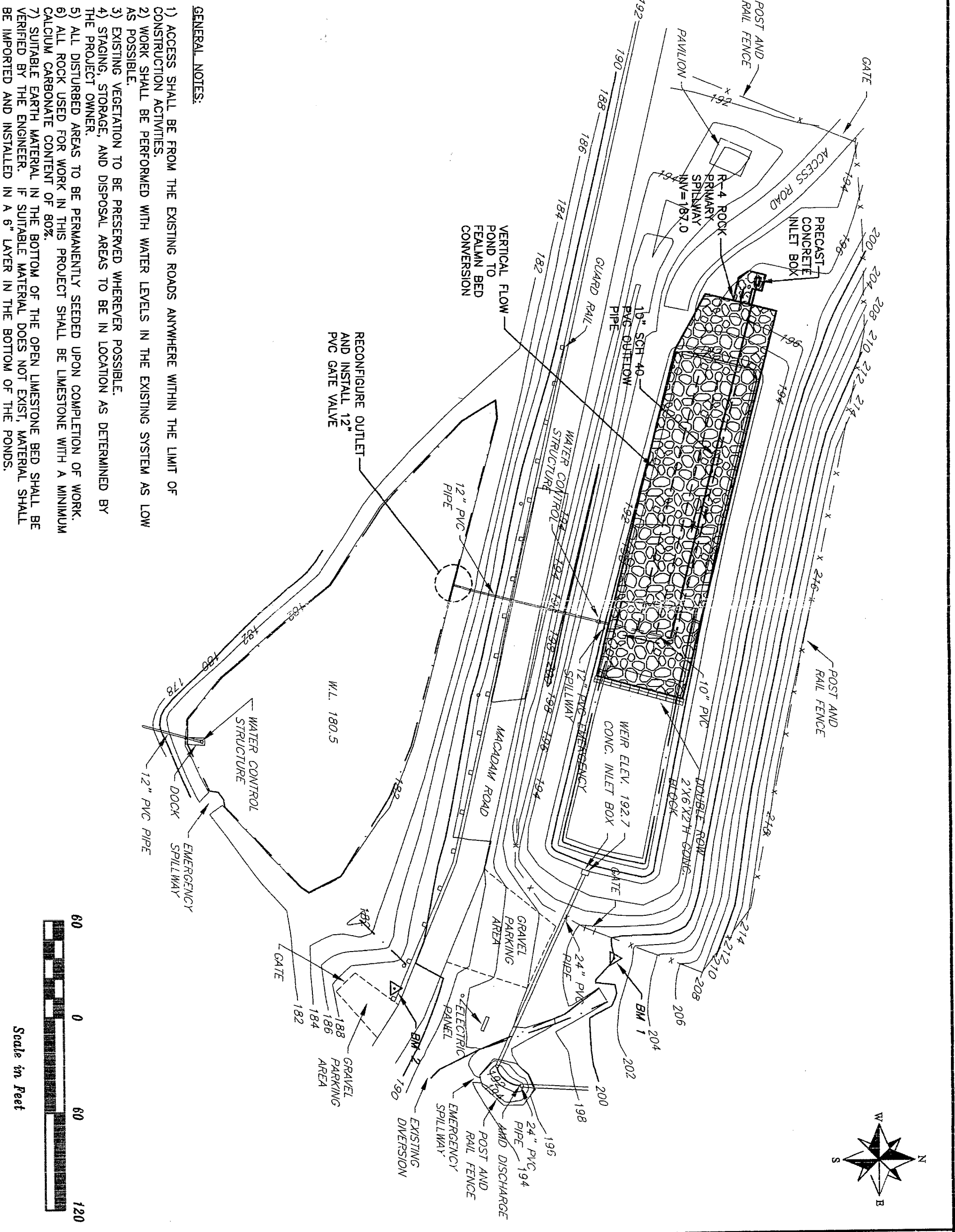

- GENERAL NOTES:**
- 1) ACCESS SHALL BE FROM THE EXISTING ROADS ANYWHERE WITHIN THE LIMIT OF CONSTRUCTION ACTIVITIES.
 - 2) WORK SHALL BE PERFORMED WITH WATER LEVELS IN THE EXISTING SYSTEM AS LOW AS POSSIBLE.
 - 3) EXISTING VEGETATION TO BE PRESERVED WHEREVER POSSIBLE.
 - 4) STAGING, STORAGE, AND DISPOSAL AREAS TO BE IN LOCATION AS DETERMINED BY THE PROJECT OWNER.
 - 5) ALL DISTURBED AREAS TO BE PERMANENTLY SEEDED UPON COMPLETION OF WORK.
 - 6) ALL ROCK USED FOR WORK IN THIS PROJECT SHALL BE LIMESTONE WITH A MINIMUM CALCIUM CARBONATE CONTENT OF 80%.
 - 7) SUITABLE EARTH MATERIAL IN THE BOTTOM OF THE OPEN LIMESTONE BED SHALL BE VERIFIED BY THE ENGINEER. IF SUITABLE MATERIAL DOES NOT EXIST, MATERIAL SHALL BE IMPORTED AND INSTALLED IN A 6" LAYER IN THE BOTTOM OF THE PONDS.

<p>WASHINGTON COUNTY CONSERVATION DISTRICT JB #2 AND SITE WASHINGTON COUNTY, PENNSYLVANIA FINAL PLAN VIEW</p>	 USDA NRCS Natural Resources Conservation Service	<table border="1" style="width: 100%; border-collapse: collapse;"> <tr> <td style="font-size: small;">Prepared by</td> <td style="font-size: small;">E. ROBERTSON</td> <td style="font-size: small;">Date</td> <td style="font-size: small;">11/08</td> </tr> <tr> <td style="font-size: small;">Drawn by</td> <td style="font-size: small;">E. ROBERTSON</td> <td style="font-size: small;">Title</td> <td style="font-size: small;">11/08</td> </tr> <tr> <td style="font-size: small;">Revised</td> <td></td> <td style="font-size: small;">Title</td> <td></td> </tr> <tr> <td style="font-size: small;">Checked</td> <td style="font-size: small;">PG</td> <td style="font-size: small;">Title</td> <td style="font-size: small;">11/08</td> </tr> </table>	Prepared by	E. ROBERTSON	Date	11/08	Drawn by	E. ROBERTSON	Title	11/08	Revised		Title		Checked	PG	Title	11/08
Prepared by	E. ROBERTSON	Date	11/08															
Drawn by	E. ROBERTSON	Title	11/08															
Revised		Title																
Checked	PG	Title	11/08															

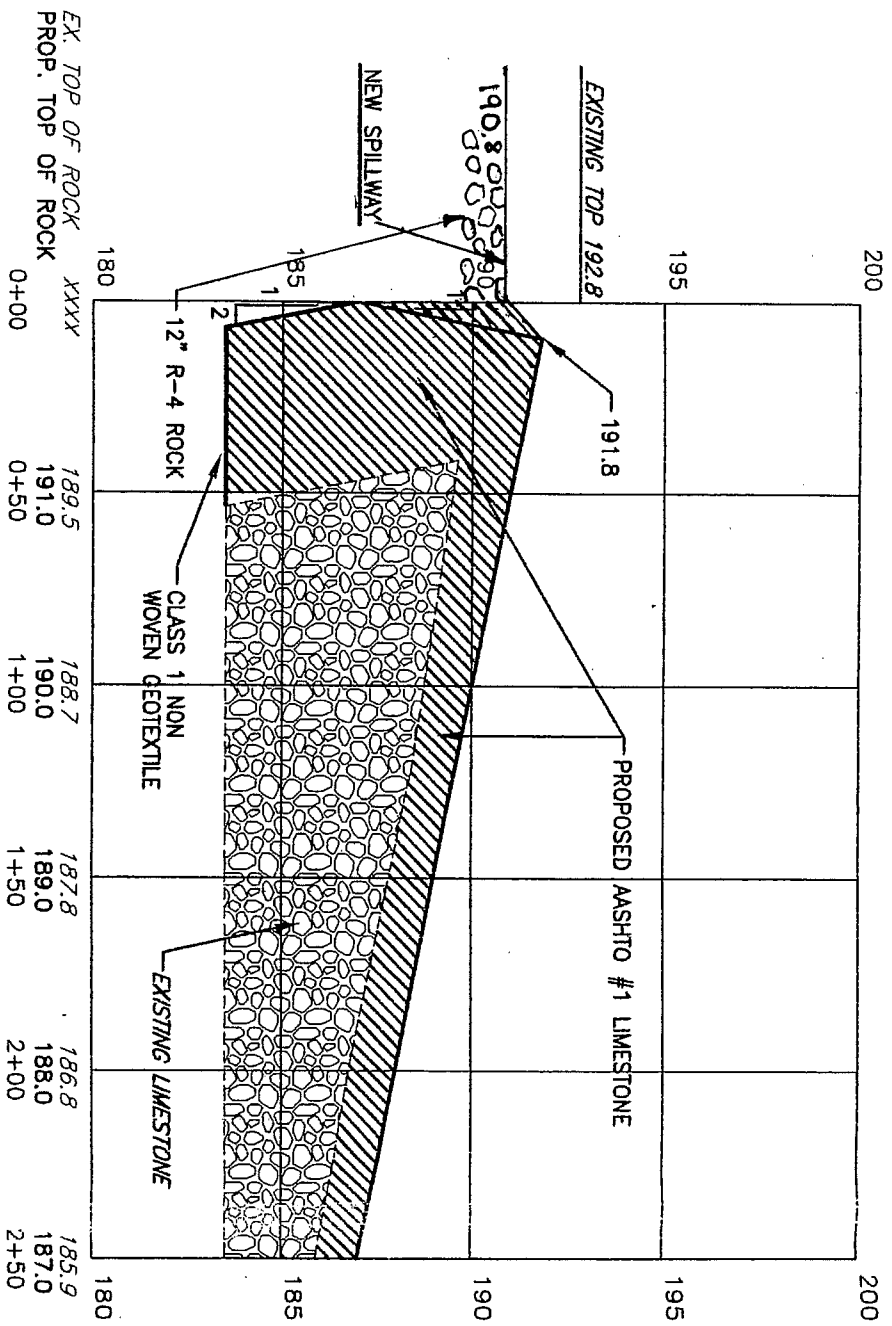

PROPOSED FEALMN BED SECTION
 SCALE: 1"=5' VERTICAL, 1"=50' HORIZONTAL

DESIGNATION	12"	6"	4"	3 1/2"	2 1/2"	2"	1 1/2"	1"	3/4"	1/2"	3/8"	#4	#8
R-4	100	50		0									
AASHTO #1	100		100	90-100	25-60		0-15						

STONE GRADATION
 (BY % PASSING)

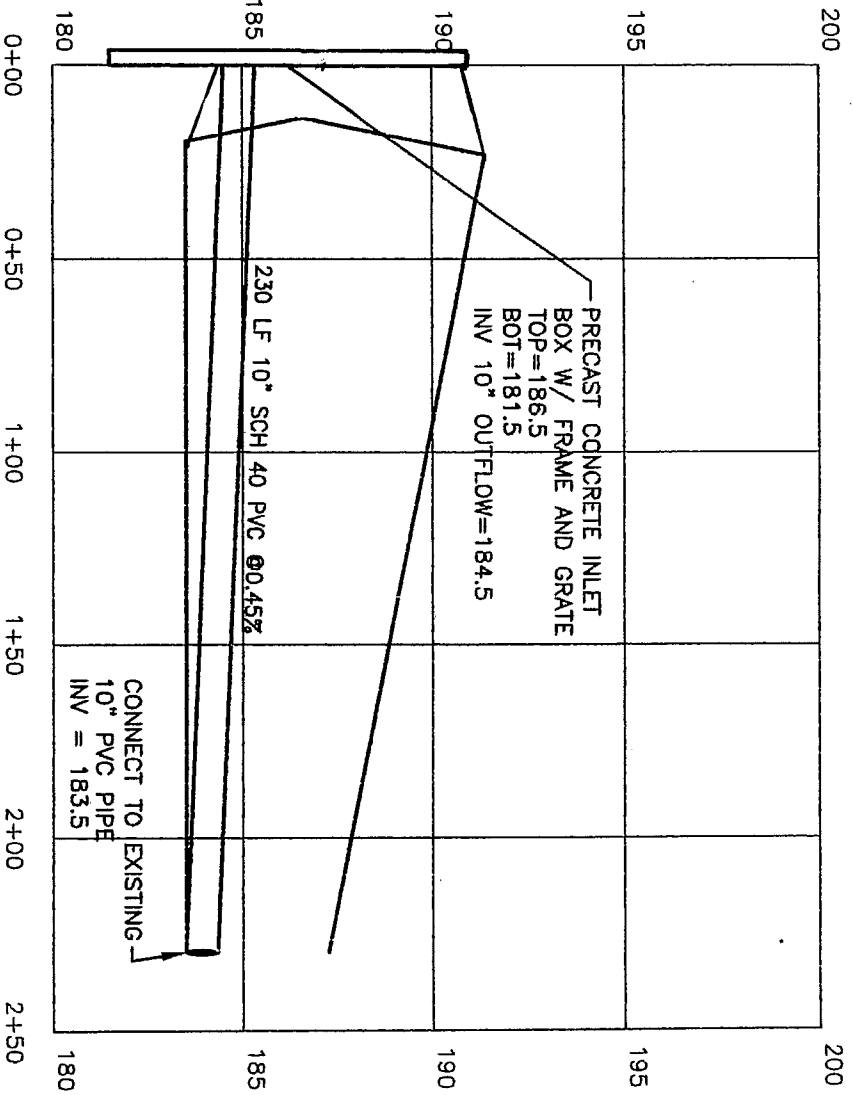

OUTFLOW SYSTEM PROFILE
 SCALE: 1"=5' VERTICAL, 1"=50' HORIZONTAL

WASHINGTON COUNTY CONSERVATION DISTRICT
JB #2 FEALMN BED CONVERSION
 WASHINGTON COUNTY, PENNSYLVANIA
PROFILES

USDA NRCS
 Natural Resources Conservation Service

Designed <u>E. ROBERTSON</u>	Date <u>11/08</u>	Approved by _____	Date _____
Drawn <u>E. ROBERTSON</u>	Date <u>11/08</u>	Title _____	_____
Revised _____	_____	_____	_____
Checked <u>PLG</u>	Date <u>11/08</u>	Title _____	_____

Sheet 4 of 5
 Drawing No. JB #2

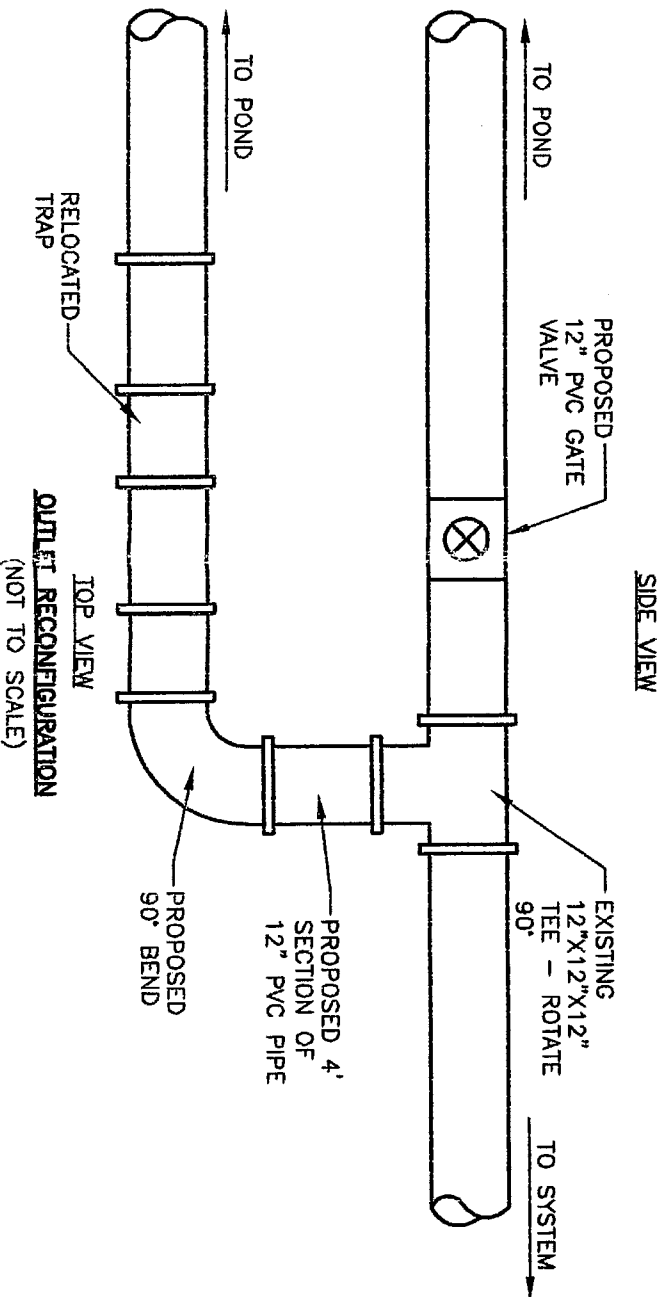
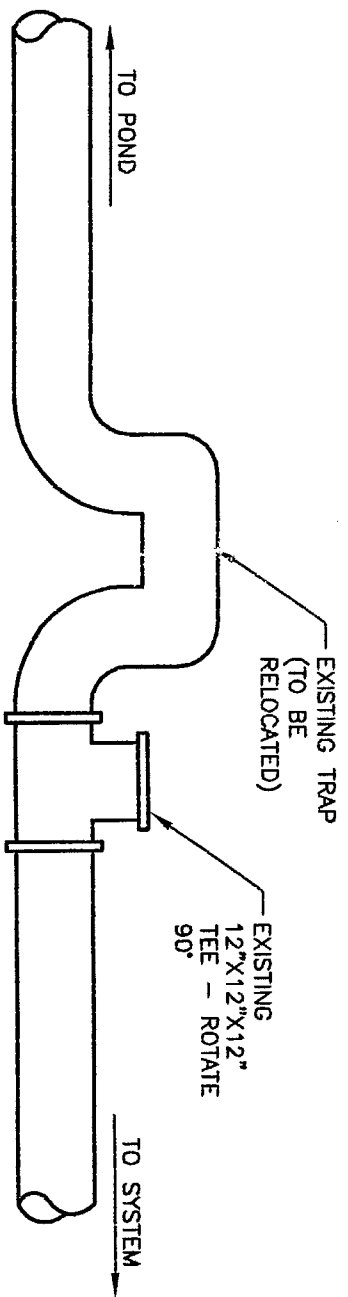
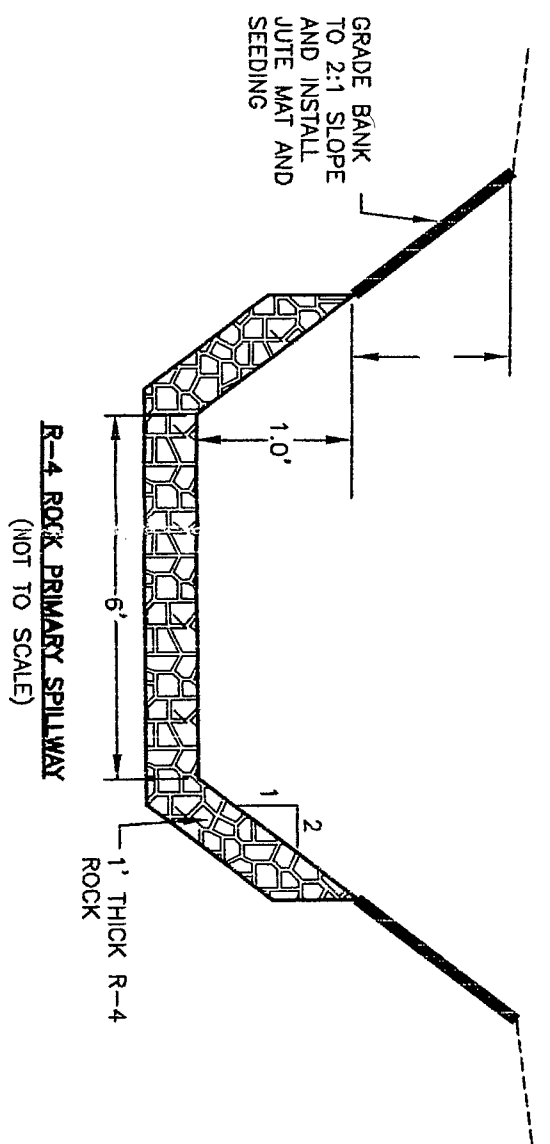

Designed <u>E. ROBERTSON</u>	Date <u>11/08</u>	Approved by _____	Date _____
Drawn <u>E. ROBERTSON</u>	Date <u>11/08</u>	Title _____	_____
Checked <u>PK</u>	Date <u>11/08</u>	Title _____	_____

USDA NRCS
Natural Resources Conservation Service

WASHINGTON COUNTY CONSERVATION DISTRICT
JB #2 AMD SITE
WASHINGTON COUNTY, PENNSYLVANIA
DETAILS

Drawing No. JB 42
Date 5/25