



0 50' 100' 150'  
SCALE 1" = 50'

**LEGEND**

- EXISTING WETLANDS (WATERS OF THE U.S.)
- EXISTING STREAM (WATERS OF THE U.S.)
- ORDINARY HIGH WATER MARK (OHWM)
- EXISTING WETLANDS
- 103.00' - EXISTING CONTOUR
- ROUTE 125 - EXISTING ROAD
- PROPOSED CONTOUR
- PHOTO LOCATION
- STAMPING LOCATION
- BENCHMARK
- SOILS BOUNDARY
- A/B
- ROAD SHOULDER
- ROAD CONSTRUCTION ENTRANCE
- ROAD SHOULDER
- ROAD CONSTRUCTION ENTRANCE

NOTES:  
1. SEE SHEET 7 FOR CROSS SECTIONS

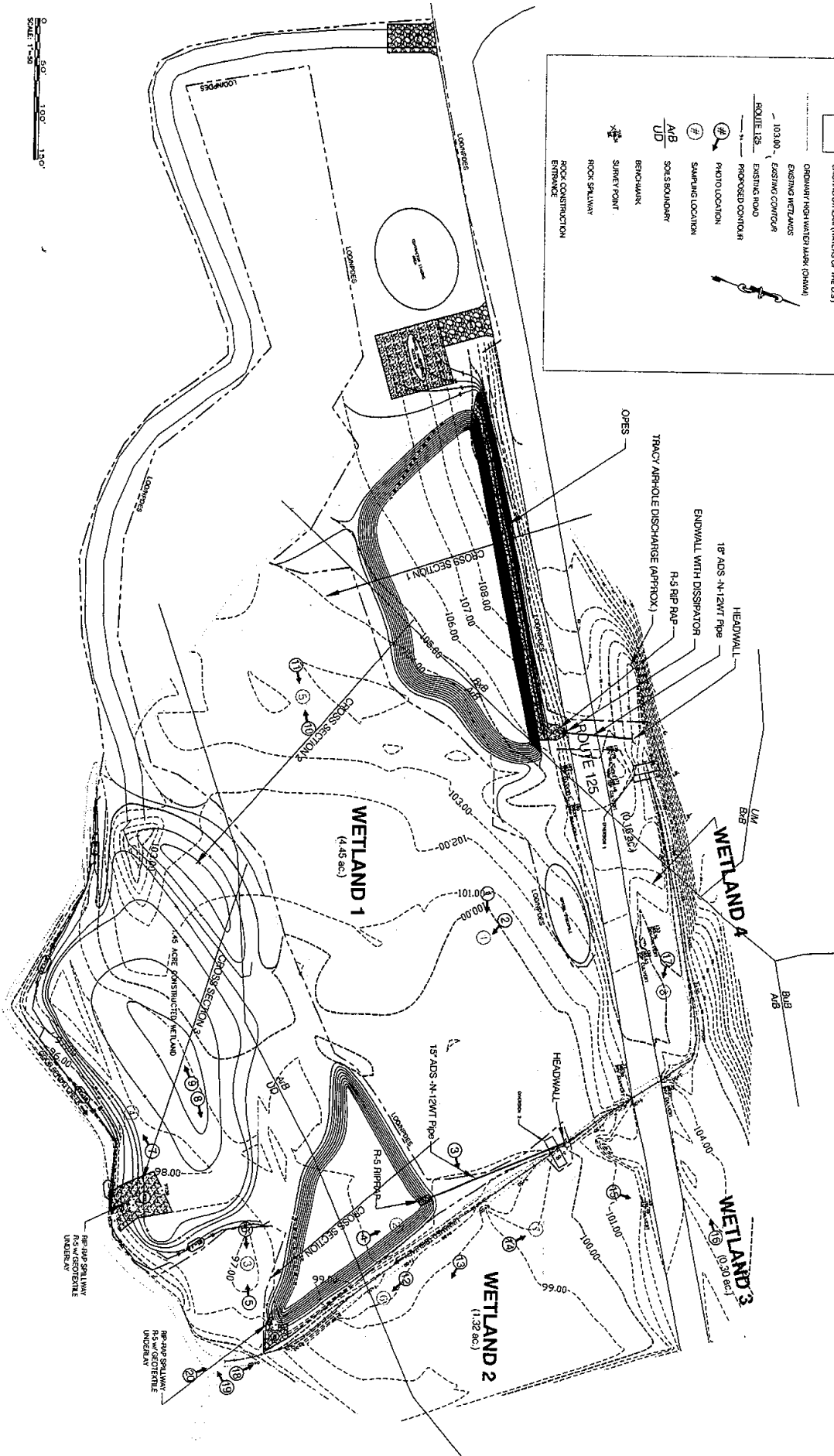

3	OF 7
---	------

NO.	DATE	REVISION

**Tracy Airhole Discharge Remediation Plan**  
**Erosion and Sediment Control Plan**  
 Fraley Twp. Schuylkill County, Pennsylvania

Client:	M. BOYD
Contractor:	K.M.V.
Design:	J.K.
Date:	8/1/07
Scale:	1" = 50'

**LandStudies**  
 315 Hixon Street  
 East Pennsboro 17543  
 tel: (717) 627-4444  
 fax: (717) 627-4660  
 email: Land@landstudies.com  
 website: www.landstudies.com  
 "Integrating Natural Resource Management with Land Planning"

- LEGEND**
- EXISTING WETLANDS (WATERS OF THE U.S.)
  - EXISTING STREAM (WATERS OF THE U.S.)
  - ORDINARY HIGH WATER MARK (OHWM)
  - EXISTING WETLANDS
  - EXISTING CONTOUR
  - ROUTE 125
  - EXISTING ROAD
  - PROPOSED CONTOUR
  - PHOTO LOCATION
  - SAMPLING LOCATION
  - AGB
  - SOILS BOUNDARY
  - UD
  - BENCHMARK

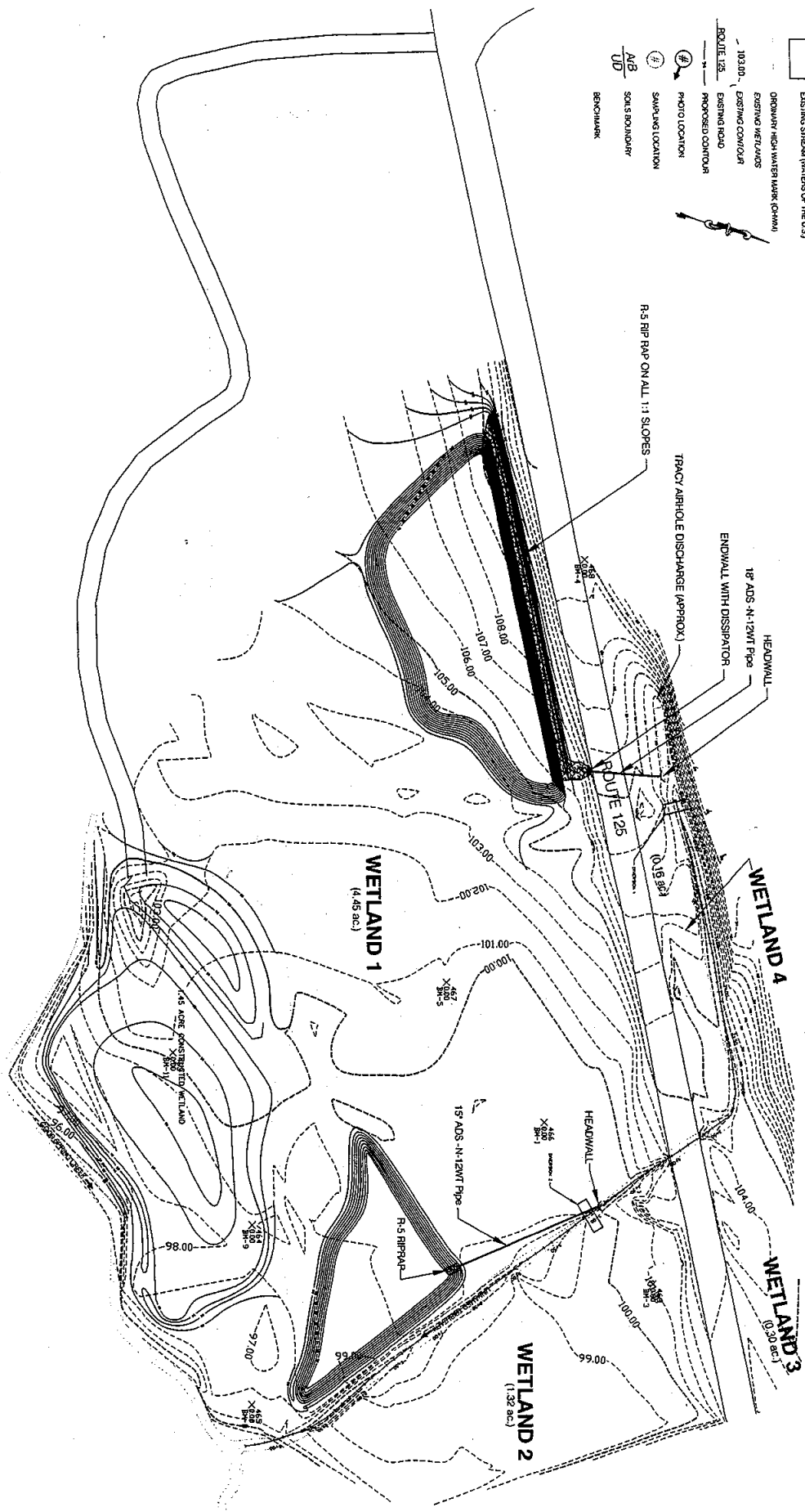

Project No.	W-130304
Drawn By	MSW
Checked By	MSW
Date	8-17-07
Scale	1" = 50'
Sheet Number	2
OF 7	

**Tracy Airhole Discharge  
Remediation Plan  
Site Plan**

Fratley Twp. Schuylkill County, Pennsylvania

**LandStudies** 215 North Street  
 13101, Pennsylvania 17304  
 Tel: (717) 627-4444  
 Fax: (717) 627-4600  
 Email: Land@LandStudies.com  
 Website: www.LandStudies.com

"Integrating Natural Resource Management with Land Planning"

HORIZONTAL SCALE: 50'  
 VERTICAL SCALE: 5'

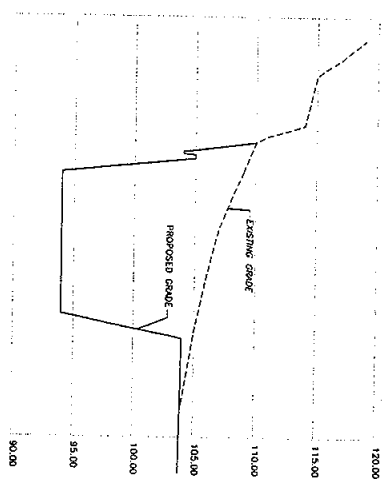

CROSS SECTION 1

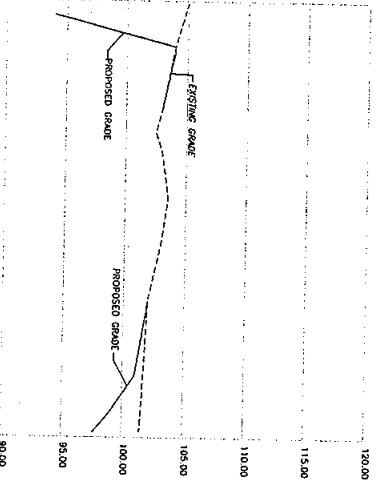

CROSS SECTION 2

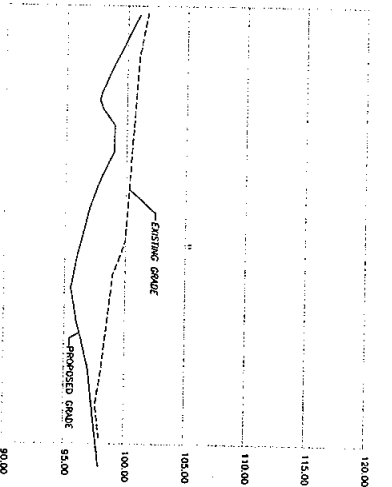

CROSS SECTION 3

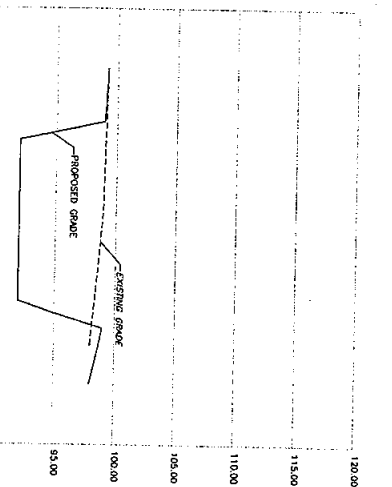

CROSS SECTION 4

**LandStudies**  
 315 North Steer  
 Luz, Pennsylvania 17543  
 TEL: (717) 627-4460  
 FAX: (717) 627-4660  
 email: Land@LandStudies.com  
 website: www.LandStudies.com  
 "Integrating Natural Resource Management with Land Planning"

**Tracy Airhole Discharge  
 Remediation Plan  
 Cross Sections**  
 Frailey Twp. Schuylkill County, Pennsylvania

Sheet Number	7
OF 7	
Project Name	Tracy Airhole Discharge Remediation Plan
Client	PA Dept. of Environmental Protection
Contract No.	8-11-01
Date	AS SHOWN
Scale	AS SHOWN
Author	AS SHOWN
Checker	AS SHOWN
Reviewer	AS SHOWN
Approver	AS SHOWN

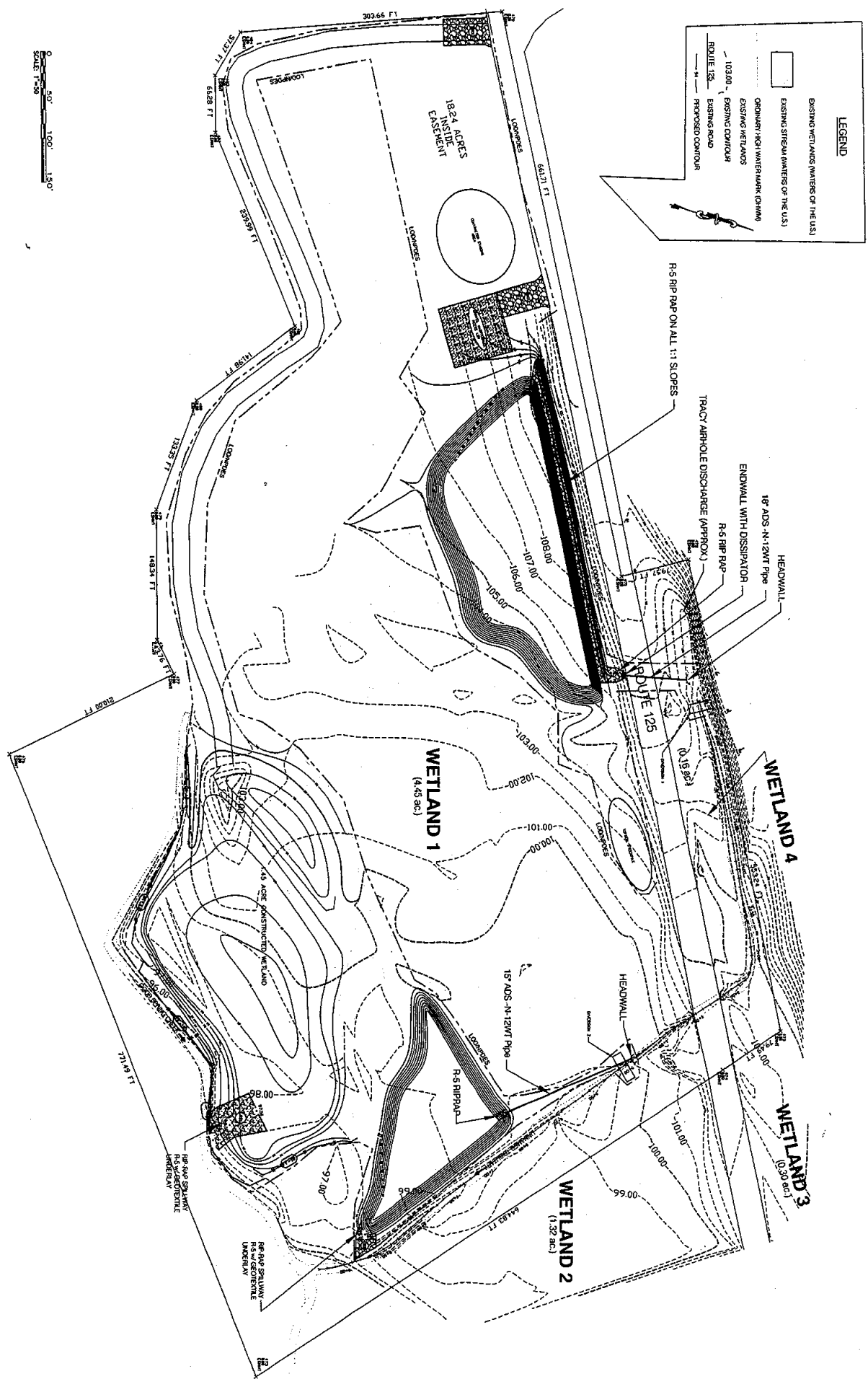
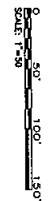

**LEGEND**

- EXISTING WETLANDS (WATERS OF THE U.S.)
- EXISTING STREAM (WATERS OF THE U.S.)
- ORDINARY HIGH WATER MARK (OHWM)
- EXISTING WETLANDS
- EXISTING CONTOUR
- ROUTE 125
- EXISTING ROAD
- PROPOSED CONTOUR

Project Name	WILKINS
Client	KIM
Date	8-17-07
Scale	1" = 50'
Sheet Number	6

**Tracy Airhole Discharge  
Remediation Plan  
EASMENT COORDINATES**

Fralley Twp. Schuylkill County, Pennsylvania

**LandStudies**

1234 Main Street  
Philadelphia, PA 19101  
Tel: (215) 555-1234  
www.landstudies.com

"Environmental Restoration and Planning"

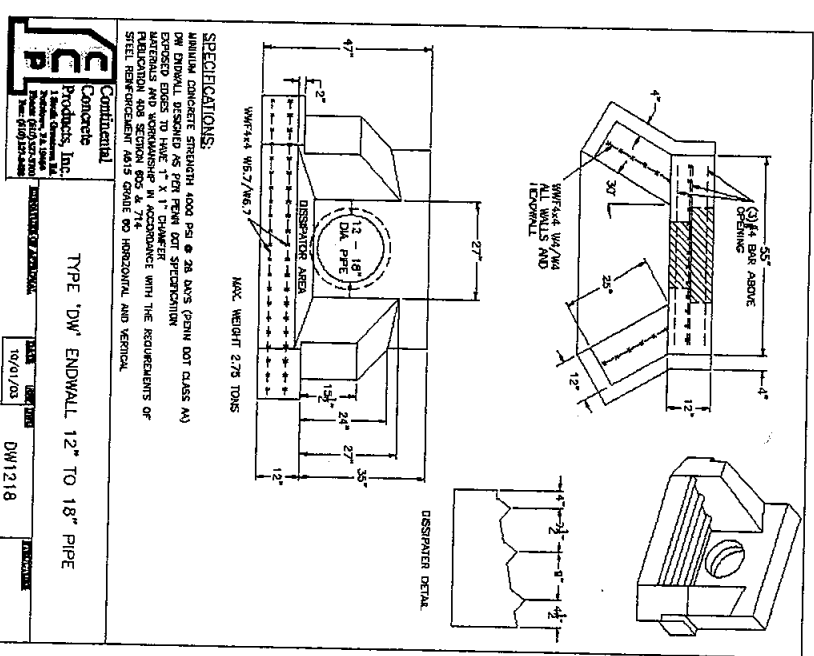
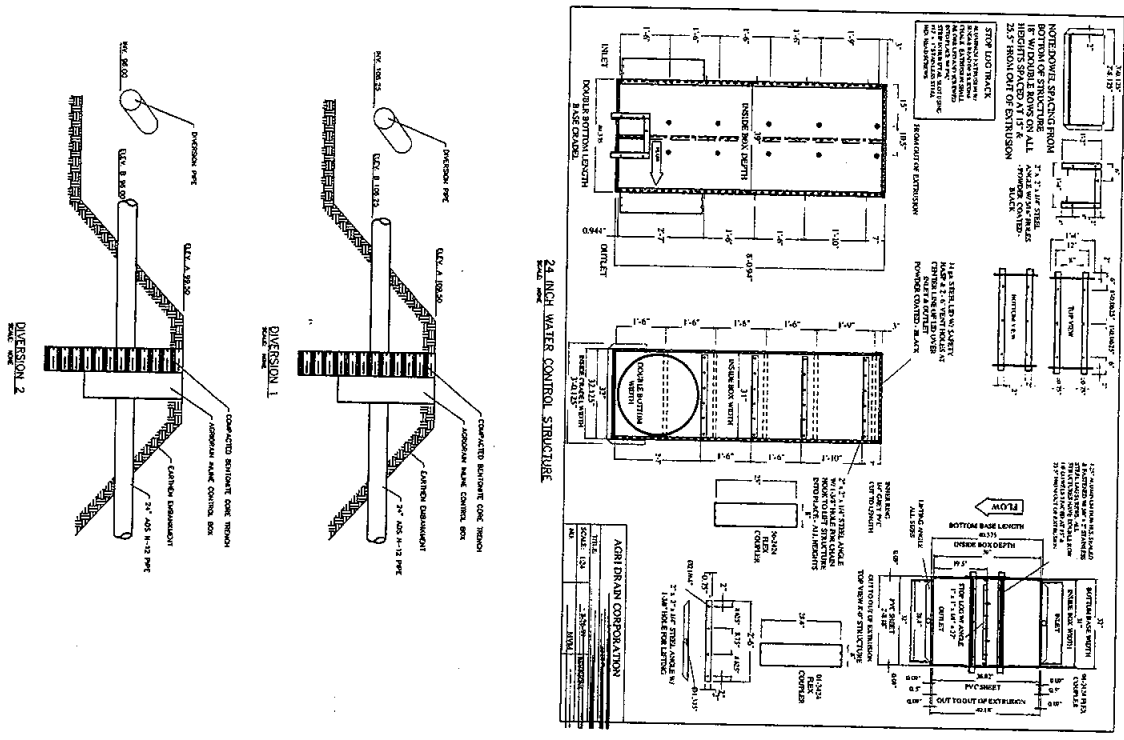

**SPECIFICATIONS:**  
 MINIMUM CONCRETE STRENGTH 4000 PSI @ 28 DAYS (PUMP OUT CLASS A)  
 DW DETAIL DESIGNED AS PER FEMA DET SPECIFICATION  
 MATERIALS AND WORKMANSHIP TO BE IN ACCORDANCE WITH THE REQUIREMENTS OF  
 FEDERAL AID SECTION 805 & 714  
 STEEL REINFORCEMENT AISI 60 HORIZONTAL AND VERTICAL

**Confidential**  
 Products, Inc.  
 1901/03  
 DW1218

ENDWALL DETAIL WITH DISSIPATOR

Project Number	WA 1218
Client	KIM
Contractor	JK
Date	8/11/07
Notes	NONE
Sheet Number	5
OF 7	

**Tracy Airhole Discharge Remediation Plan Detail Sheet**  
 Frailey Twp., Schuylkill County, Pennsylvania

**LandStudies**  
 315 North Street  
 1871 Pottsville, PA 17842  
 Tel: (717) 627-4440  
 Fax: (717) 627-4660  
 Email: Land@LandStudies.com  
 Website: www.LandStudies.com  
 "Integrating Natural Resource Management with Land Planning"

